

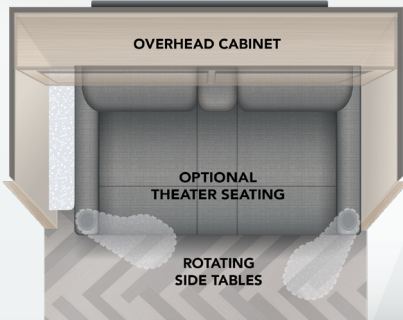

**18RBE**

**S P A R K**

**\* AVAILABLE THEATER SEATING OPTION**  
RECLINING WALL-HUGGER THEATER SEATS WITH CUP HOLDERS AND ROTATING SIDE TABLES CAN BE OPTIONED IN PLACE OF THE BOOTH DINETTE



OPTIONAL THEATER SEATING

ROTATING SIDE TABLES

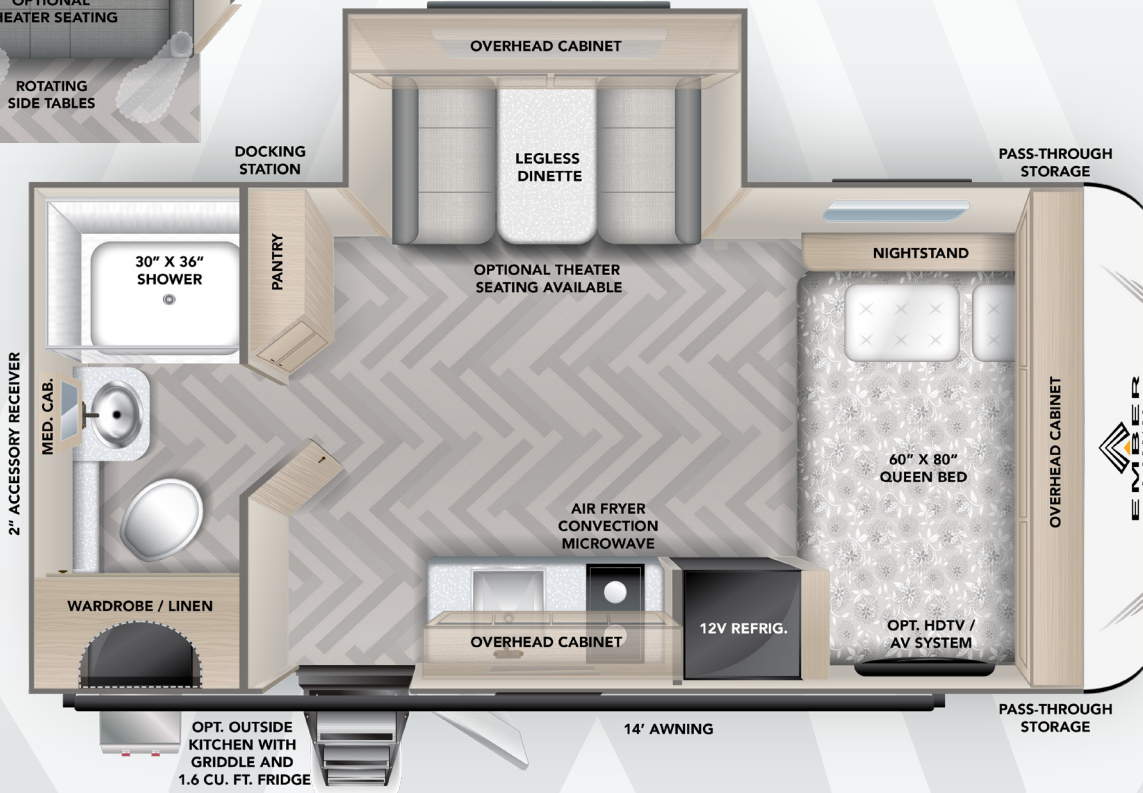

SPECIFICATIONS	LENGTH	HEIGHT	DRY WEIGHT	HITCH WEIGHT
18RBE	TBD	11'3"	TBD LBS	TBD LBS

### KEY FEATURES

- 18,000 BTU Max Cool "Whisper Quiet" A/C (Largest Single A/C in Class) with Remote
- Goodyear Endurance® Tires (Load Range E)
- Laminated Azdel Onboard® Composite Walls
- Best-in-Class 82" Ceiling Height
- Full 8' WIDTH (96") vs. Typical 7' or 7.5' Width
- True Residential Queen Size 60" x 80" Front Bed (vs. "RV Queen")
- Congoleum® DiamondFlor® "Carpetless" Interior
- Air Fryer Convection Microwave
- XL 55 gal. Fresh, 35 gal. Gray & Black Tanks
- Seamless Countertop with Stainless Steel Kitchen Sink and Pull-out Sprayer Faucet
- EmberLink™ "Smart RV" system controls Slide Room, Awning, and Lighting
- "Legless" Booth Dinette with Storage Below
- Optional Wall-hugger Theater Seating
- Optional Outside Kitchen with Griddle and 1.6 Cu. Ft. Mini-Fridge
- Optional Off-grid Solar Package with (2) 200W Rooftop Panels (400W total), 2000W Inverter, and Victron® MPPT Solar Controller
- Sleeps 2 - 4

Please Note: Information on this flyer is the latest available at the time of publication approval. Ember Recreational Vehicles reserves the right to make changes and to discontinue models without notice or obligation. RVs built for sale in Canada may differ to conform to Canadian codes. EMBER is a registered trademark of Ember Recreational Vehicles, Inc. ©2024 EMBER RECREATIONAL VEHICLES, INC. REV240829

## STANDARDS

### Construction

- Laminated Azdel® Composite Walls
- Best-in-Class 82" Ceiling Height
- Aluminum-framed Sidewall Construction
- Gel-coated Fiberglass Exterior
- Aluminum-framed Laminated Floor
- Fully Walkable Roof with One-piece Tufflex® PVC Roofing (Lifetime Warranty)
- Dexter® Axle with E-Z Lube Hubs and Forward Self-Adjusting Electric Brakes

### Exterior

- 15" Goodyear Endurance® Load Range E Tires (including spare; Made in the USA!)
- Custom Aluminum Rims
- Adjustable Solid Step™ Entry Stairs
- Slam-Latch Baggage Doors
- Electric Awning with LED Lighting
- Front Electric Tongue Jack with LED Light and Built-In 7-Way Cable Holder
- Front and Rear Quick Drop™ Stabilizers
- High-Visibility LED Exterior Lighting
- Back-Up Lighting
- Fully-Enclosed Radiant Barrier Underbelly
- XL Fresh Water Tank (55 gallons)
- Dual 20# LP Tanks (40# total capacity)
- LP Quick Connect
- 30 Amp Service
- Detachable Shore Power Cord
- Battery Disconnect
- Outside Shower
- Black Tank Flush
- 30" Friction-Hinge Entrance Door
- Frame-Integrated Rear 2" Accessory Receiver (300# capacity)
- Winegard Air 360+ Omnidirectional Antenna (Wi-Fi/LTE Prep)
- Keyed-Alike™ Locking System
- Coiled Break-Away Cable
- PREPPED FOR: Solar Upgrades (Side and Rooftop Solar Ports), Rear/Side Observation Camera, Tire Pressure Monitoring System (TPMS), Inverter, Slide Topper, and Starlink Cable

### Interior

- 18,000 BTU Max Cool "Whisper Quiet" A/C (Largest Single A/C in Class)
- 60" x 80" Residential-Sized Queen Bed with USB-A, USB-C, and 120V Powered Cubbies with LED Lights on Each Side
- EmberLink™ Smart RV Control System
- 12V Refrigerator (10 cu. ft.)
- Air Fryer Convection Microwave
- Hardwood Framed Cabinet Doors with Hidden Hinges
- Soft Close Hardwood Drawers
- Roller Shades
- Seamless Countertops
- Stainless Steel Kitchen Sink with Pull-out Sprayer Faucet
- Dual-burner Cooktop
- Congoleum® DiamondFlor® "Carpetless" Interior
- Tankless "On Demand" Water Heater
- Porcelain Foot-Flush Toilet
- 20K BTU Furnace
- Medicine Cabinet
- Bathroom Skylight and 12V Fan
- Smoke/CO/LP Detectors
- Fire Extinguisher

## OPTIONS

- 32" 12V "Smart" TV with Built-In JBL® Soundbar Bluetooth® AV System
- 12V Multi-speed Fan (Main Room)
- Theater Seating (in place of Dinette)
- Repositionable/Telescoping Roof Ladder
- Thermostatically-Controlled 12V Tank Heaters (Fresh, Gray, Black)
- Wireless Side/Rear Observation Camera System with 12V Monitor
- Tire Pressure Monitoring System (TPMS)
- Outside Kitchen with Griddle (Connects to LP Quick Connect) and 120V Mini-Fridge (18RBE, 19DBE)
- Off-Grid Solar Package: Dual GoPower!® 200W Rooftop Solar Panels (400W total), 2000W Pure Sine Wave Inverter, and Victron® MPPT Solar Controller



**FURRION CHILL™**  
**18K BTU "WHISPER QUIET" CHILL® CUBE VARIABLE SPEED ROOFTOP AIR CONDITIONER LARGEST AIR CONDITIONING SYSTEM IN OUR CLASS!**

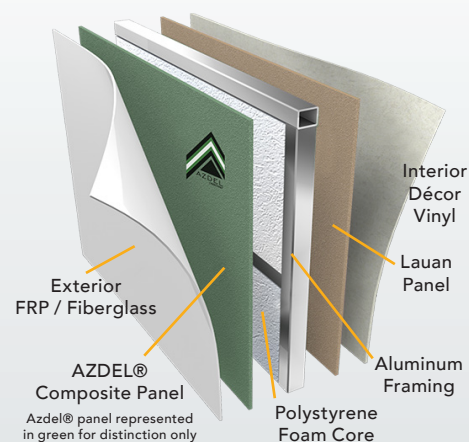

**E-SERIES SIDEWALL CUT-AWAY LAMINATED AZDEL ONBOARD® COMPOSITE WALLS WITH ALUMINUM FRAMING AND GEL-COATED FIBERGLASS**



## NOTES